

Quick Start Guide

We highly recommend that you to follow along this video tutorial to assemble your bike. Simply scan the QR code below.



Or visit:

velotricbike.info/nomad1

This guide will get your new bike set up and ready to ride.

- **What's in the Toolkit**
- **Bike Assembly**
- **Bike Diagram**

What's in the Toolkit



Tool Bag

- a** Socket Wrench
- b** Phillips Screwdriver
- c** M15/M8 Wrench
- d** M10 Wrench
- e** M6/M5/M4/M3/M2.5 Hex Key

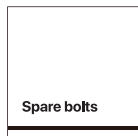
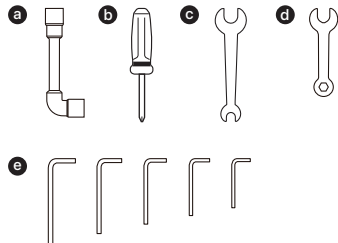

Spare bolts

- a** Front Hub Cap / Washer × 2
- b** Stem Clamp Bolt × 2
- c** Display Panel Bracket Bolt × 2
- d** Display Panel Mount Bolt × 2
- e** Fender Bolt × 1

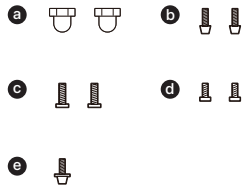

What's in the Toolkit

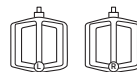

Left / Right Pedal



Front / Rear Reflector



Bell

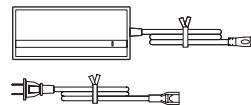

Adapter & Charging Cable



Display

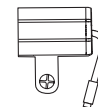

Front Light



Kickstand



Hub Cap



Cable Binder

Step 1 Kickstand

Bike Assembly

1. Put on the hub cap.
2. Unscrew the bolts for the kickstand with the M5 hex key.
3. Attach the kickstand and tighten the bolts.

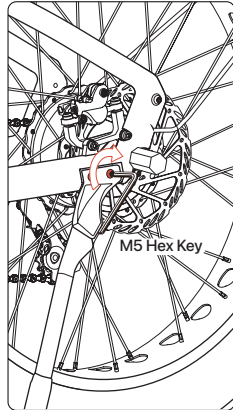
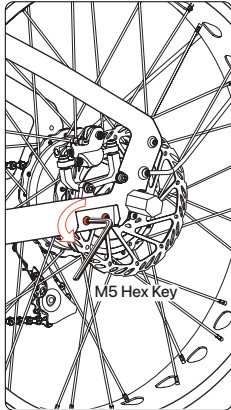
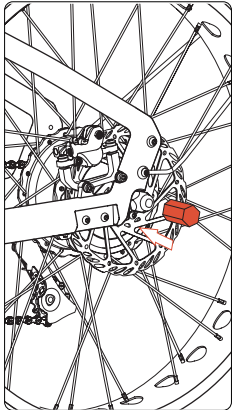

Bike Assembly

Step 2 Handlebar

1. Remove the four bolts on the clamp with the M4 hex key and install the handlebar.
2. Adjust the handlebar by aligning the reference marks.
3. Tighten the four bolts in the order illustrated below.

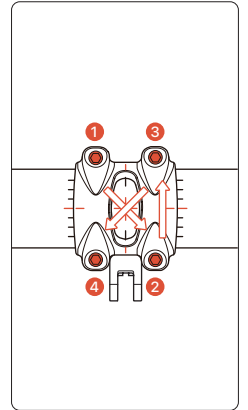
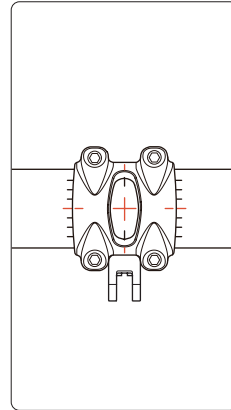
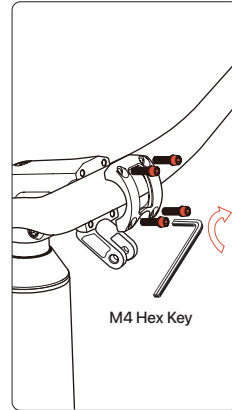

Step 3 Front Wheel

Bike Assembly

1. Open the quick release lever.
2. Unscrew the quick release knob, and remove the quick release from the fork protective tray.
3. Remove the spacer from the brake caliper.

▲ NOTE The quick release is ONLY for this fork protection tray as a protection setup for transportation. You may trash it while unboxing. The quick release is NOT for Front Wheel assembly.

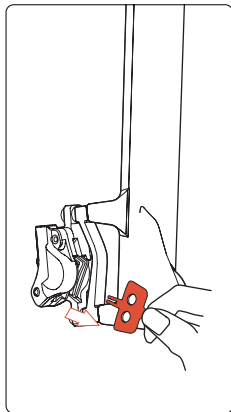
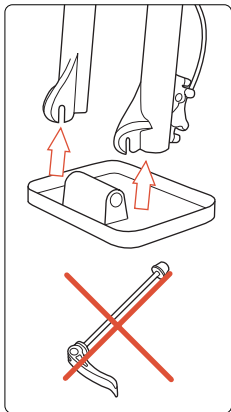
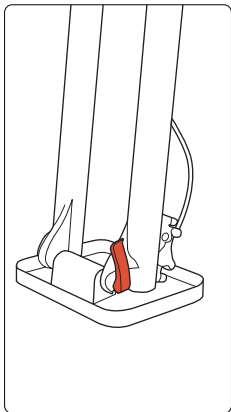

Bike Assembly

Step 3 Front Wheel

4. Insert the front wheel to the front fork. Seat the hub axle into the dropouts.
5. Tighten and secure the front hub cap with the socket wrench (Torque 30–35 Nm).
6. Ensure the rotor is well-positioned (with gap) inside the brake caliper.

▲ NOTE 1. Torque can be measured by using a torque wrench.
2. Be careful not to accidentally squeeze the brake levers before this step. Otherwise you may cause misalignment on your hydraulic brakes.

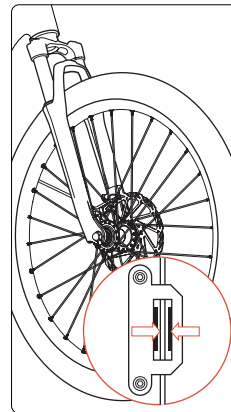
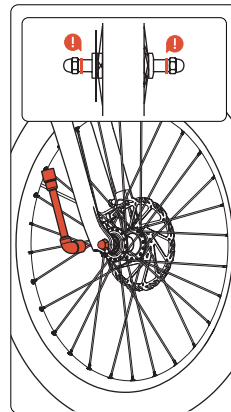
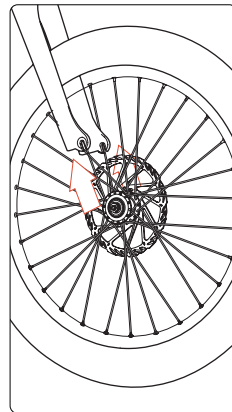

Step 4 Front Fender

Bike Assembly

1. Unscrew the bolts that affix the front fender to the fork top.
2. Attach the support rods to the fork legs with the M4 hex key.
3. Adjust the fender to your own preference. Ensure the wheel is centered and the gap between the fender and the wheel is clear. Fasten the bolts.

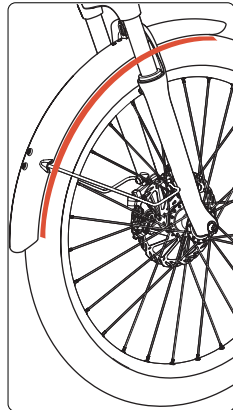
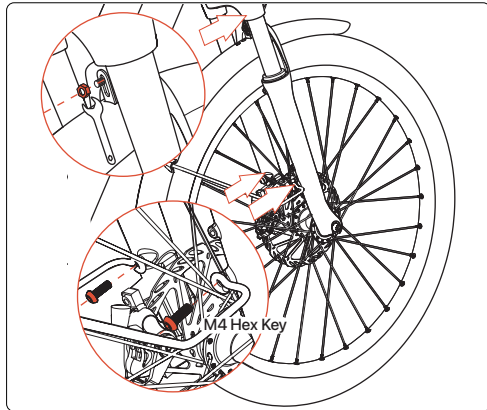

Bike Assembly

Step 5 Pedals

1. Attach the right pedal to the right crankset by turning the pedal CLOCKWISE (see below).
2. Tighten the pedal with the M15 wrench.
3. Attach the left pedal to the left crankset by turning the pedal COUNTER-CLOCKWISE (see below).
4. Tighten the pedal with the M15 wrench.

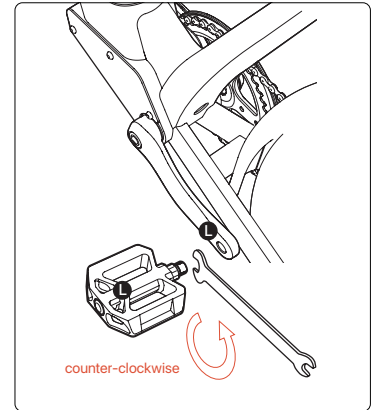
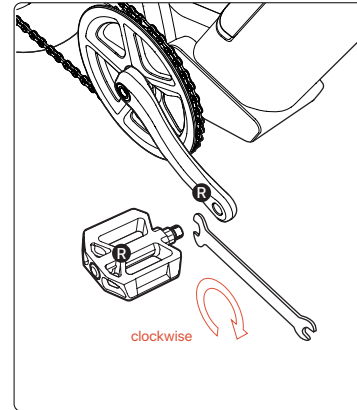

Step 6 Front Light

Bike Assembly

1. Attach the front light to the mount.
2. Fix the light to a desirable angle with the Phillips screwdriver and M8 wrench.
3. Connect the two front light cables (in red) as shown below.

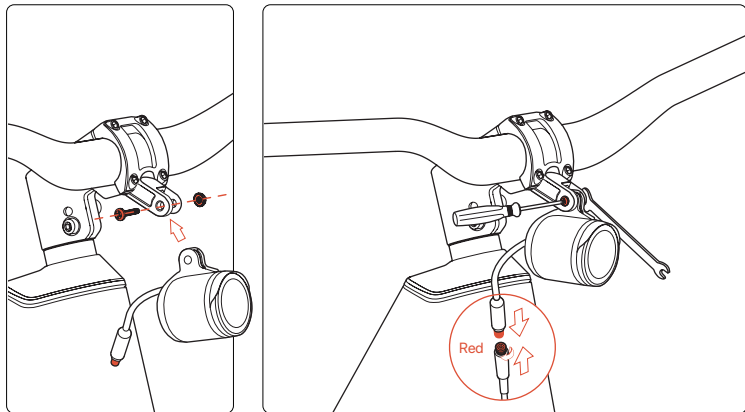

Step 7 Display

Bike Assembly

1. Unscrew the bolts on the mounting brackets of the display.
2. Mount the display panel onto the handlebar and adjust it to an angle you can view easily on the seat in a riding position. Tighten the bolts with the M3 hex key.
3. Connect the display cables (marked green and blue) as shown below.
4. Wrap the display wires together with the connected front light cable with the cable binder.

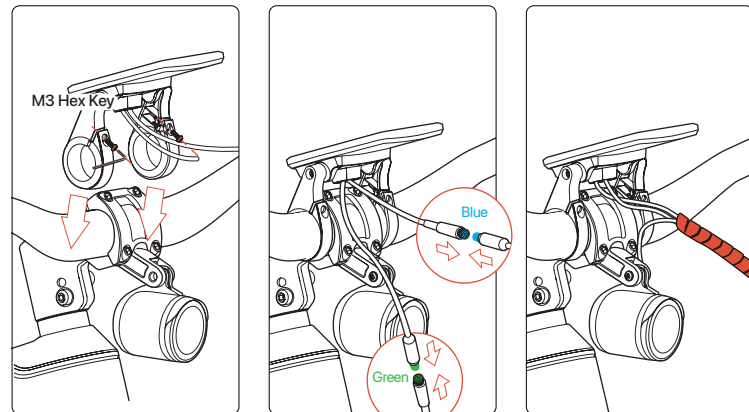

Step 8 Bell and Front/Rear Reflector

Bike Assembly

1. Unscrew the bolt on the bell mount and install the bell. Adjust the angle before tightening the bolt.
2. Unscrew the bolt on the reflector mount and install the reflector. Adjust the angle before tightening the bolt.
3. Attach the rear reflector to the seat post. Adjust the angle before tightening the bolt.

▲ NOTE You can position the bell and reflector according to your preference.

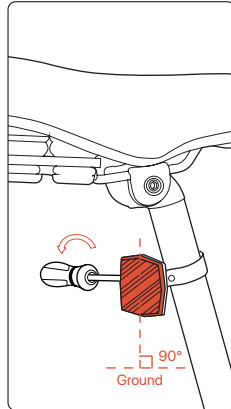
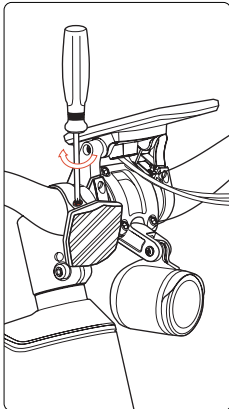
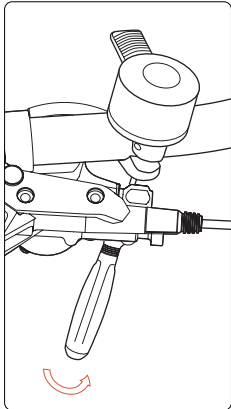

Bike Assembly

Step 9 Stem Angle

1. Adjust the stem to make the handlebar perpendicular to the front wheel.
2. Tighten the bolts on both sides of the stem.

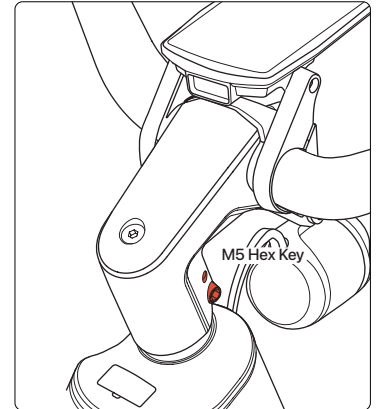
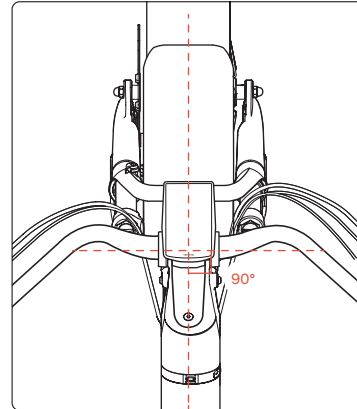

Step 10 Battery

Bike Assembly

1. Fit the battery into the down tube.
2. Insert the key into the battery lock.
3. Press firmly to nest the battery and turn the key clockwise to lock it in place.

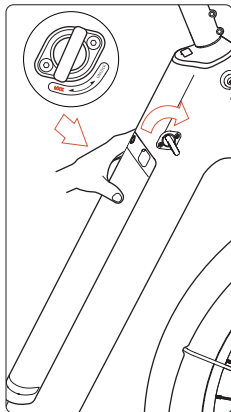
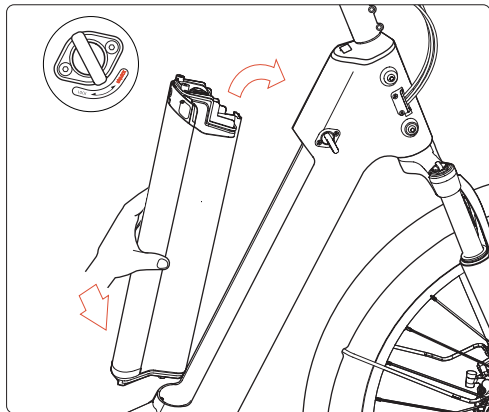

Bike Assembly

Step 11 Charging

1. The battery can be charged either in or out of the bike. Power off the bike before charging the battery in the bike.
2. Make sure the battery is placed on a flat and clear surface. Plug the DC power cord (barrel connector) into the port.
3. Plug the adapter into the wall. The LED indicator will turn red.
4. The indicator will turn green when the battery is fully charged. Unplug the adapter first before pulling out the cord from the battery.

- ▲ WARNING** 1. Charge the battery in an environment from 50–86°F (10–30°C).
2. The battery won't charge when it is over 113°F (45°C) or below 32°F (0°C). Let the battery adjust to room temperature for at least 1 hour before trying again.

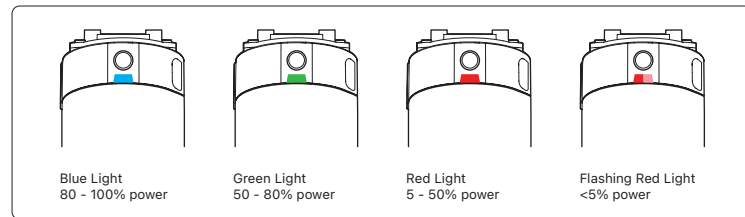
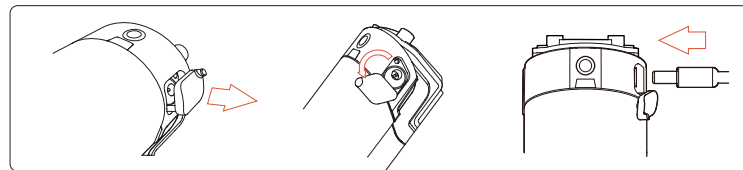

Step 12 Start Your Bike

Bike Assembly

1. Peel the protective film off the display screen.
2. Hold the on/off button to power on/off the bike.
3. Our system provides different levels of pedal assistance (1 = lowest, 5 = highest) so you can adapt the power output depending on your riding needs. Level 0 means no pedal assist.

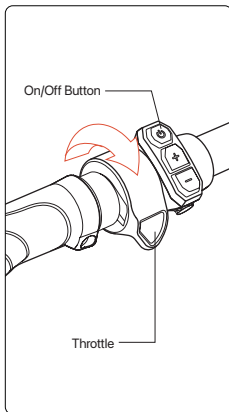
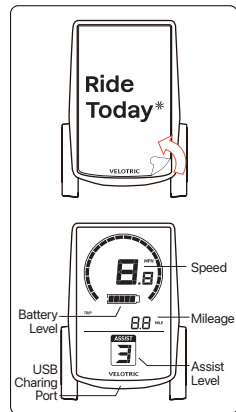

Assist level 1

Eco Mode: Minimal power output for maximum battery efficiency.

Assist level 2

Tour Mode: Low power output for riding long distances.

Assist level 3

Normal Mode: Medium power output for city commuting.

Assist level 4

Sport Mode: Strong power output for active riding.

Assist level 5

Turbo Mode: Maximum power output for extreme riding.

Bike Assembly

Step 13 Test the Features

When the display is on:

1. Hold the "+" button to turn on the **front light**. The display will dim automatically. Hold the "+" again to turn off the light, and the display lights up again.
2. Press "+/-" to shift the **pedal assist level** up or down.
3. Hold the "-" button to turn on Walk Mode at 2.5mph (4km/h). Release the button to turn off **Walk Mode**.

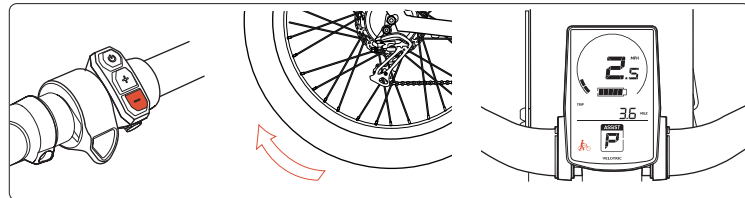
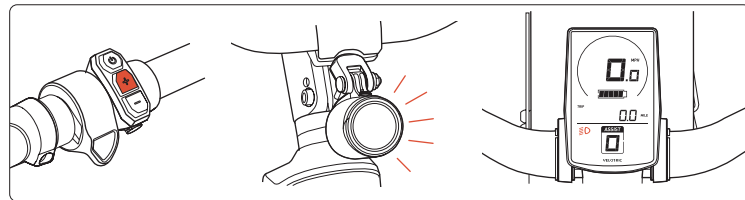

Step 14 Tire Pressure Check

Bike Assembly

Always check your tires before a ride. If the tires seem soft or spongy, pump them up to the pressure indicated on the side of the tire.

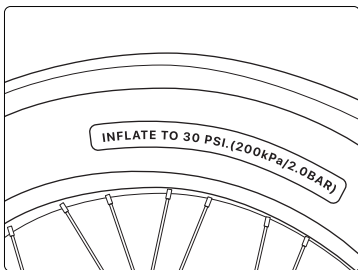
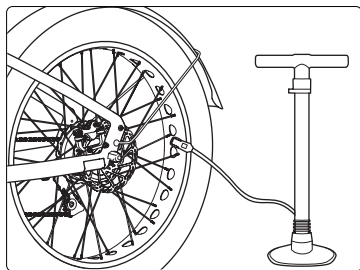
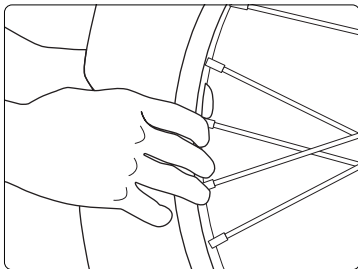
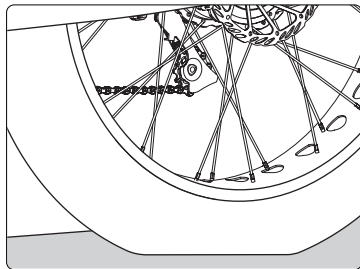

Bike Diagram



- | | | |
|------------------|-------------------|--------------------|
| 1 Front Light | 7 Motor | 13 Battery |
| 2 Handlebar | 8 Cassette | 14 Brake Rotor |
| 3 Stem | 9 Rear Derailleur | 15 Brake Caliper |
| 4 Saddle | 10 Chain | 16 Tire |
| 5 Seatpost | 11 Crankset | 17 Suspension Fork |
| 6 Seatpost Clamp | 12 Pedal | |

Bike Diagram



-
- a** Brake Lever
 - b** Throttle
 - c** Remote
 - d** Bell
 - e** Shifter
 - f** Grip
 - g** Display

Define
Your
Adventure.

VELOTRIC

Contact

Website: www.velotricbike.com

E-mail: help@velotricbike.com

Phone: +1 888-559-3099

Hours: Monday-Friday, 7AM-6PM PST

