

# FIND MY

---

How to Connect My eBike	62
How to Enable Lost Mode	64
How to Disable Lost Mode	66
How to Remove My eBike	68
How to Restore Factory Setting	70

## How to Connect My eBike

Follow these steps to pair your eBike with the Find My app.

1. Long press the **(P)** button for 2 seconds to power on.
2. Long press the **(M)** button for 2 seconds to enter MENU, select "Find My", then single press the **(M)** button.
3. Select "Find My", and single press the **(M)** button. Once the eBike emits a sound, it is now ready to be paired.

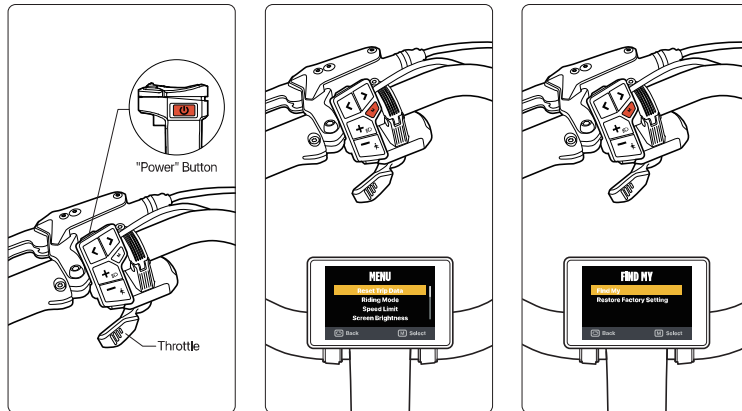

62

## How to Connect My eBike

4. Open the Find My app on your device. Under the 'Items' section, tap [Add Item].
5. Tap [Other Supported Item].
6. When your eBike is detected, tap [Connect]. Follow instructions within the Find My app to complete the pairing process.

**Note** Please complete the pairing within 5 minutes in the Find My app.

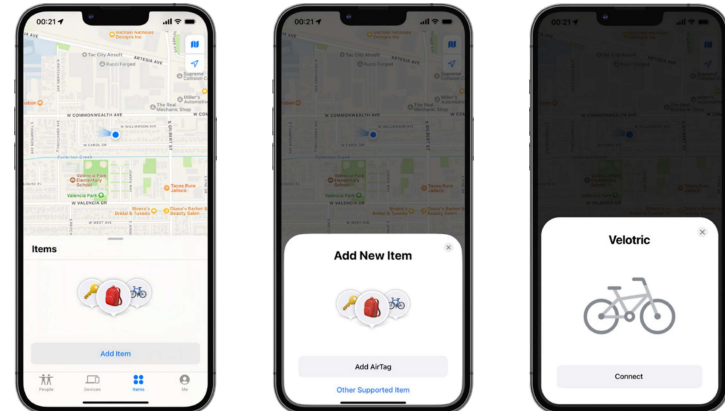

63

## How to Enable Lost Mode

If your eBike is lost, please follow these steps to activate "Lost Mode" and locate your eBike.

1. Select your eBike from 'Items' list.
2. In Lost Mode, tap [Enable].

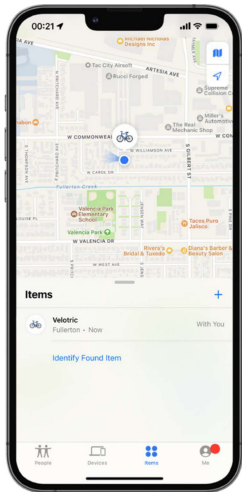

64

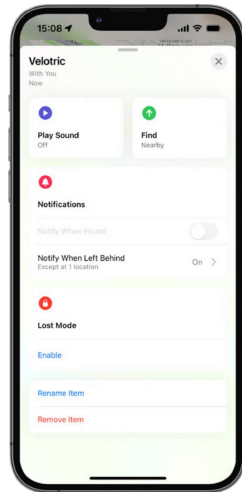

## How to Enable Lost Mode

3. Read "WHAT WILL HAPPEN?" first, then tap [Continue].
4. Enter your phone number or email, then tap [Activate] to activate Lost Mode.

**Note** If your eBike is locatable, other users can tap [Identify Found Item] in the Find My app to help identify your eBike.

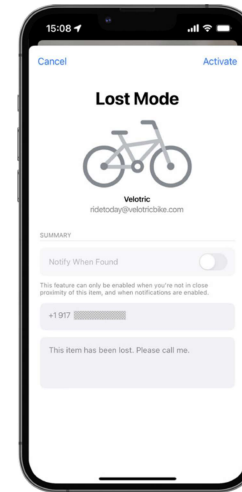
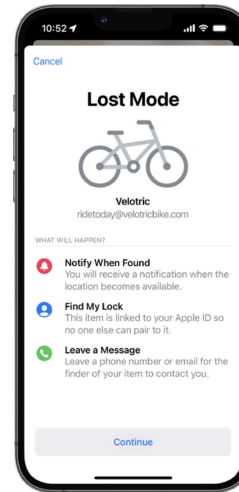

65

## How to Disable Lost Mode

Once your eBike is found, follow these steps to turn off 'Lost Mode'.

1. Select your eBike from 'Items' list.
2. In Lost Mode, tap [Enabled].

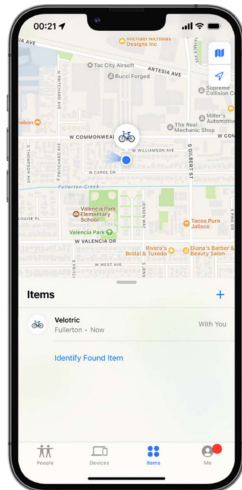

66

## How to Disable Lost Mode

3. Tap [Turn Off Lost Mode]. You have now turned off Lost Mode.

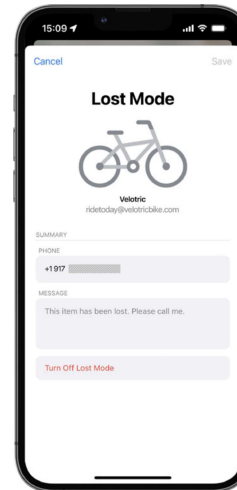
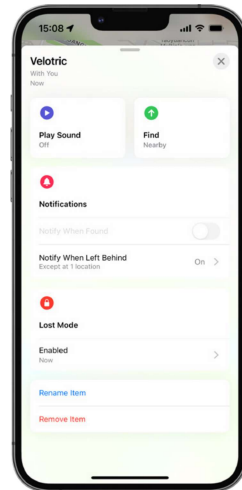

67

## How to Remove My eBike

Follow these steps to remove your eBike from the 'Find My' network if you are no longer using this eBike.

1. Select your eBike from 'Items' list.
2. Scroll down to the bottom and tap [Remove Item].

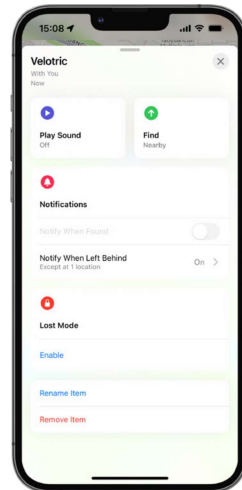
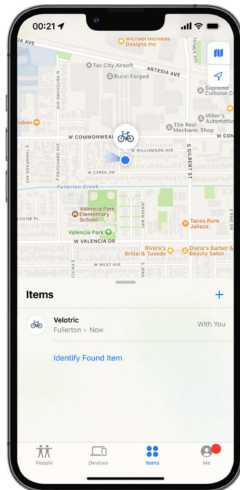

## How to Remove My eBike

3. In the 'Remove Item' page, tap [Remove], and the eBike will be removed from your item list.

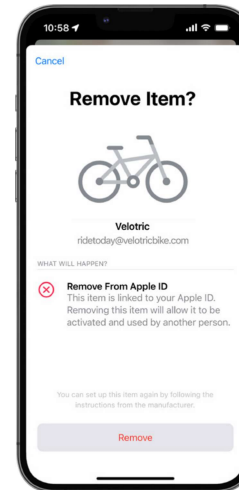

## How to Restore Factory Setting

If the eBike is offline when removing from Find My app, restore factory setting will allow you to unpair the eBike.

1. Long press the **[P]** button for 2 seconds to power on. Long press the **[M]** button for 2 seconds to enter MENU. Select "Find My" and then single press the **[M]** button.
2. Select [Restore Factory Setting] and single press the **[M]** button. Next, select [Confirm] and single press the **[M]** button again. When you see the 'Success' prompt and hear the eBike emit a sound, the factory reset was successful.

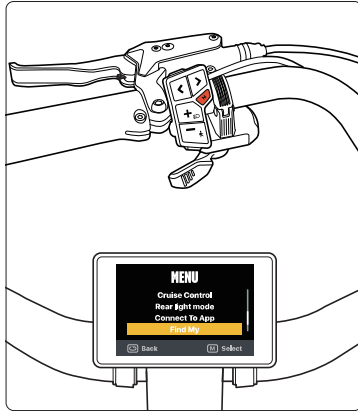

70

# OPERATION INSTRUCTION

Power, Throttle & Pedal Assist  
Throttle on Demand

72  
73

71